

Specifications

Motor type	3phase-4poles-6slots Inner rotor type brushless motor
Rated voltage	12 V
Rated load	52 mNm
Rated speed	3,000 rpm
Rated output	16 W (25 °C)
Operating temperature range	-40 ~ 125 °C (continuous) 150 °C (intermittent)

* Some customization is available, with commutation sensors, connector installation, etc.

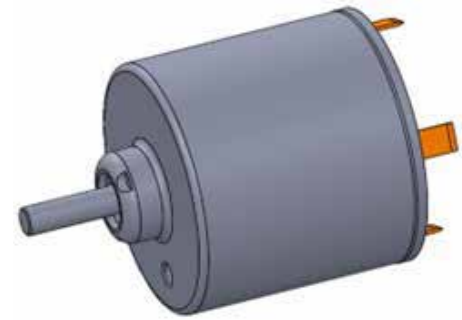

- UVW winding terminals
- Without commutation sensors

Characteristics

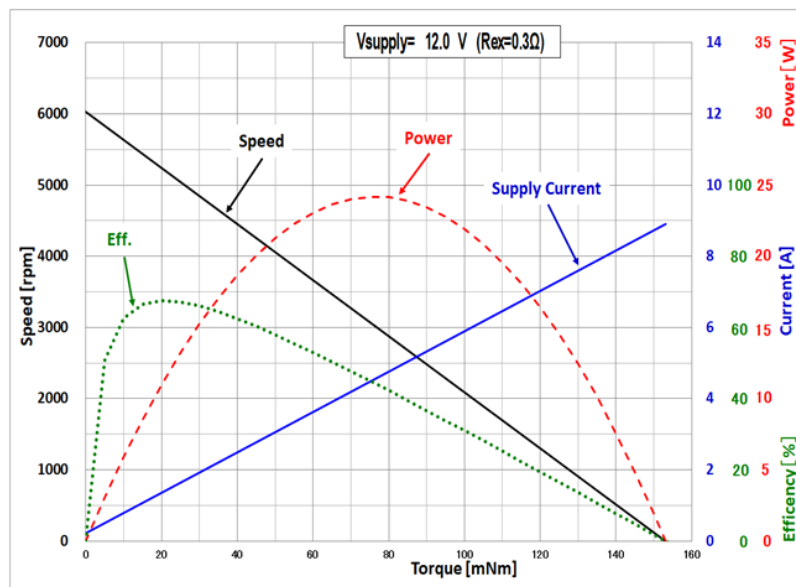

Outline

