

IP55 Cooling Fans

AIR MOVERS



NMB Technologies provides Ingress Protection (IP) rated cooling fans – IP55 provides dust proof and protection against harsh environments and is for outdoor applications. These 60mm to 120mm IP55 rated fans are available in 12V, and 24V with tachometer output for speed monitoring. Fans are outfitted with NMB precision machined stainless ball bearings for long life, corrosion resistance and high reliability.

Features

- ◆ IP55 rating per IEC 60529 standard
- ◆ Long life and high reliability with NMB precision machined stainless steel ball bearings
- ◆ Low power and high efficiency designs
- ◆ Open Drain Tacho output
- ◆ Competitively priced

Applications



Factory Automation
Food Processing
Horticulture



Refrigeration
LED Lighting
Inverters



Telecom



EV Charging

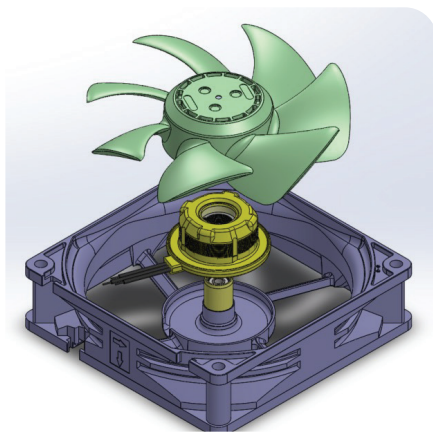

Expected Lifetime

40,000 Hrs @ 60°C to 100,000 Hrs @ 25°C*

*Reference Data available upon request

Material

Casing: Plastic (Black) 94V-0

Impeller: Plastic (Black) 94V-0

Bearing: Stainless Steel

Lead Wire: UL3385 AWG 26/Red +/Black -/ White (Tacho)



Specifications

| NMB P/N | Size (mm) | Width (mm) | Rate Voltage (v) | RPM | Air Flow (m ³ /Min) | Air Flow (CFM) | Pressure (Pa) | Pressure (Inch H ₂ O) | Power (W) | Noise (dB) |
|-------------------|-----------|------------|------------------|------|--------------------------------|----------------|---------------|----------------------------------|-----------|------------|
| 06025SE-12R-FT-DW | 60 | 25 | 12 | 6000 | 0.85 | 30.0 | 101 | 0.405 | 2.76 | 38.5 |
| 06025SE-24R-FT-DW | 60 | 25 | 24 | 6000 | 0.85 | 30.0 | 101 | 0.405 | 2.40 | 38.5 |
| 08025SE-12Q-FT-DW | 80 | 25 | 12 | 4100 | 1.55 | 54.7 | 68 | 0.273 | 3.12 | 39.5 |
| 08025SE-24R-FT-DW | 80 | 25 | 24 | 4500 | 1.70 | 60.0 | 82 | 0.329 | 4.08 | 42.0 |
| 09225SE-12Q-FT-DW | 92 | 25 | 12 | 3900 | 1.84 | 65.0 | 73 | 0.293 | 3.00 | 40.0 |
| 09225SE-24Q-FT-DW | 92 | 25 | 24 | 3900 | 1.84 | 65.0 | 73 | 0.293 | 3.12 | 40.0 |
| 11925SE-12R-FTD-W | 119 | 25 | 12 | 3500 | 3.63 | 128.2 | 89 | 0.357 | 7.44 | 47.0 |
| 11925SE-24R-FTD-W | 119 | 25 | 24 | 3500 | 3.63 | 128.2 | 89 | 0.357 | 7.20 | 47.0 |